

CD PLAYER

w/ Build-in
Speaker



CONTENT	FEE
Arafuna portable CD player with built in speaker	\$65
Carrying case	\$15
USB to type C charging cable	\$10
3.5 to 3.5 mm Aux cable	\$10
User manual	--

Please return at the Adult Reference Desk

CD PLAYER
w/ Build-in
Speaker



Circulation	3 weeks
Renewals	1x
Overdue fines	\$3



QUICK GUIDE

CD PLAYER

with built-in speaker

Arafuna CD5189B

31030155089006

Charge

Red light = charging
Green = fully charged

**connect charging cable to
USB port/charger to charge**

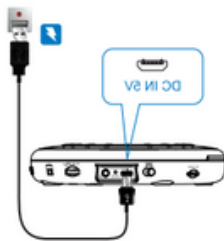

Power on

Push the power switch to ON. The player will enter standby mode after 20 seconds with no use, restart by pressing play. 

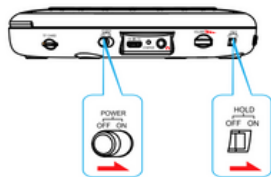

Play disk

When NOD is displayed on the screen, check if the disc is placed correctly in the player.

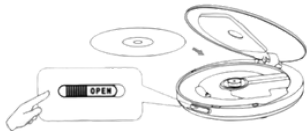

This player can be as a stand-alone speaker or connect to a external speaker, ex: Car, via AUX cable

Last memory

The last memory function is turned on by default. Long press **PROG** button for 3 seconds to turn on/off the last memory function. The ON or OFF will be displayed on the screen at this time.

ON =After the player is turned off and restarted it will be returned to the last stop-track on the disc.

OFF =After the player is turned off and restarted, it will start playing from the first track on the disc.

Use the Play/Pause button or turn CD player off to return to the last stop-track on the disc. The STOP button returns play to the first track on the disc

MODE

Each time MODE button is pressed, the order of the tracks played will be:
Rep 1 =Repeats current track
ALL =Repeats all tracks
RAND=Random play
INTRO=First 10 seconds per each track

EQ

Press to change sound effects: BBS (bass), POP, JAZZ, ROCK, and CLASSIC



Next button: short press ; Fast forward: long press



Previous button: short press ; Rewind: long press

PROG

Enters programming mode. Press PREVIOUS or NEXT buttons to select the track you want to program, press PROG again to confirm the programming. Then press PLAY button to enter the programming play mode. Press the STOP button to enter the stop mode to cancel or reprogram.

HOLD

Locks the operation of all the keys. Found under the CD player.

AUX

Plug cable into headphone port to connect to home theater, or car.

-VOL+

Located next to the headphone port.

Speed-/+

Adjusts playback speed 5 levels.